

# CERAMENT® BONE VOID FILLER

## Preparation of paste



### PRE-MIX INSTRUCTIONS

- Open device on sterile field.
- Keep sterile and do not discard the bottom of the tray which contains Tip Extenders and embedded wrench tool.
- Prepare a Stop Watch.
- Proceed to mixing instructions below.

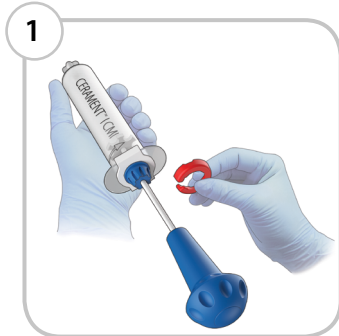

1 Remove red plunger stop ring from large powder syringe (CMI).

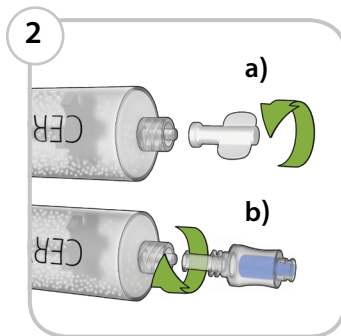

2 a) Unscrew plug from large powder syringe.  
b) Twist to attach clear end of valve to the luer lock of the large powder syringe.

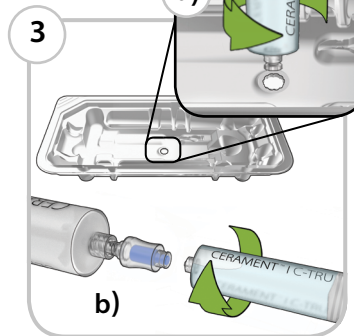

3 a) Unscrew plug of liquid filled syringe (C-TRU) using provided tool embedded in tray bottom.  
b) Push and turn to attach liquid filled syringe to blue end of valve.

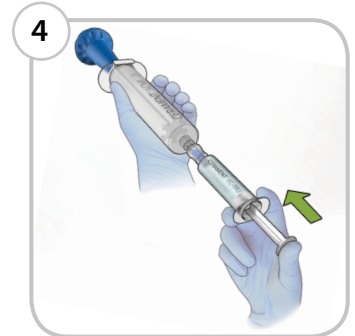

4 Transfer liquid into large powder syringe. Remove and discard empty syringe leaving valve attached to the large powder syringe.

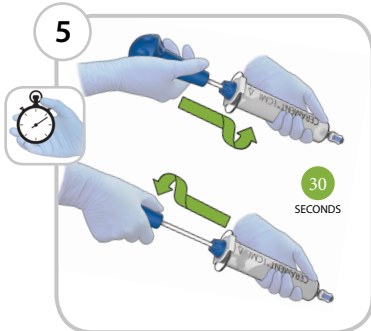

5 Start stop watch and mix for 30 seconds. Use care to push and retract fully while twisting the blue handle at the end positions of each stroke.

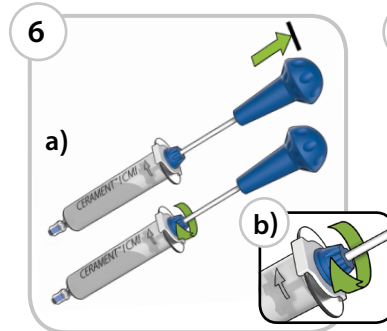

6 a) After mixing, fully retract blue handle.  
b) Turn small blue collar clockwise to engage plunger. Note: be sure to fully turn collar or product will not transfer.

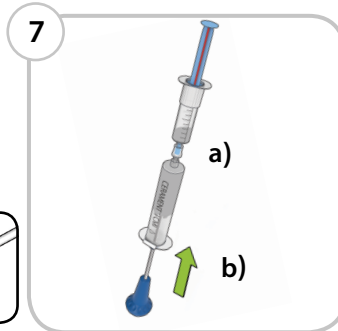

7 a) Push and turn luer lock of the delivery syringe (ID) to attach to the blue end of the valve.  
b) Transfer paste into empty delivery syringe. When completely filled, excess paste starts oozing from the air vent hole by the sleeve on the delivery syringe.

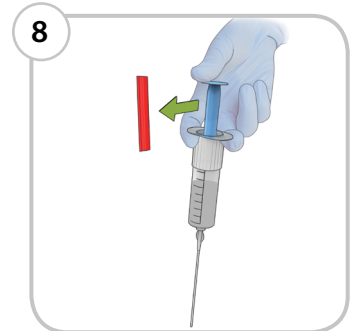

8 Remove red plunger stop. If applicable attach Tip Extender. Refer to time charts on next page for bone defect filling options.

**Filling of the bone defect (void/gap) - 3 different options**



*All timelines are calculated from the Start of Mixing and vary slightly depending on product use*

**Injection**

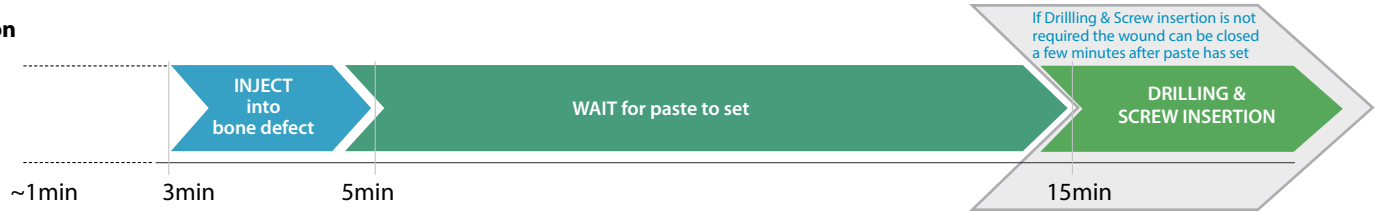

**or Molded by hand\***

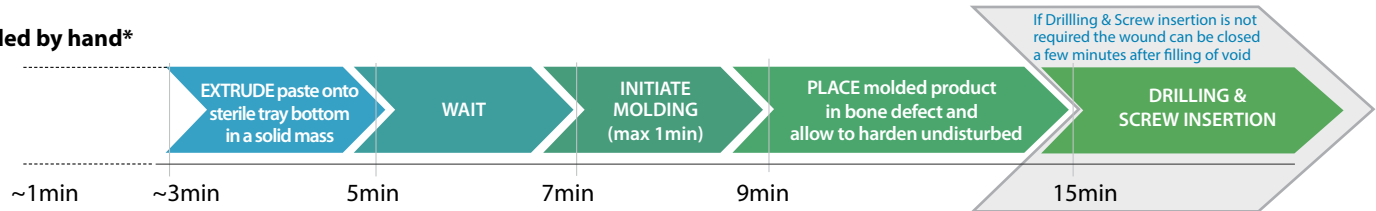

**or Molded with use of Bead Mold Trays\*\***

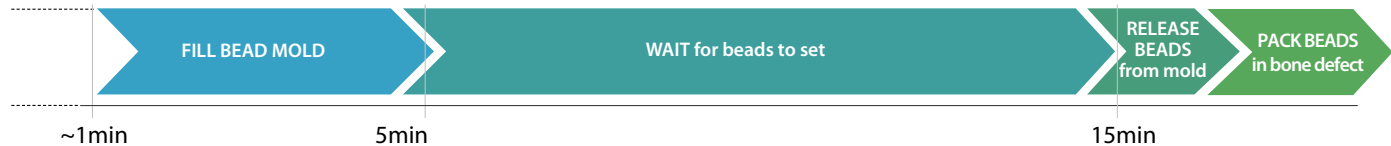

\* NOTE: Do not manipulate or touch extruded paste unnecessarily before initiation of molding.

\*\* Bead Mold not included in pack.